



CLADDING INSTALLATION GUIDE



Pages

Tips & Advice	03
Handling & Storage	04
Recommended Tools & Safety Equipment	05
Batten Supports	
Installing Composite Battens	06
Cladding & Accessories	
Installing Assured Cladding Boards	07 - 08
Installing Assured Corner Trim	09
Installing Assured Fascia	10



Need help? Get in touch.

+44(0) 1664 400140

info@assuredcomposite.com

www.assuredcomposite.com

Tips & Advice

- Use a minimum of 2 people to make the project easier.
- Plan all areas and think about what is trying to be achieved.
- Measure twice to ensure the correct measurements are taken before cutting any material.
- Ensure all working areas are clear and free from any obstacles to avoid damage or injury.
- Pre-drill holes where necessary to avoid splitting materials.
- Ensure starter clips are 20mm from your cladding starting point.
- Ensure starter clips are level to support the weight of the cladding boards.
- Double batten where cladding boards meet for support.
- Fix supporting blocks to battens to support cut cladding boards where required.
- Use a membrane where required.
- Allow expansion gaps where advised to avoid unnecessary repairs.
- Only leave a maximum 20mm cladding board overhang.
- Use Assured Fasteners and Fixings with Assured products.
- Refer to manufacturers user manual before using tools if unsure.
- Always wear safety equipment.
- Always have safety in mind.

TIPS & ADVICE



Looking After Composite

When handling and storing Assured Composite products follow the advice of our experts, this helps prevent damage and injury before installation.

- When moving any Assured Composite product please ensure the correct safety equipment is worn.
- Check that the area where the products are being placed is clear and free from any obstacles.
- Ensure the ground is a flat hard surface and place battens every 450mm approx intervals to support cladding boards and battens above the ground.
- We advise that 2 people move cladding boards and battens. This is down to the weight and length.
- Do not drag or slide any cladding boards or battens especially when laying on top of one another.
- Allow 24 hours for products to get used to the environment before installation.
- Any cladding boards or battens stored for a long period of time inside or out will need covering.

HANDLING & STORAGE



Safety Matters

When installing any outdoor project this needs to be completed as safely and efficiently as possible, so ensure you have the right tools available which have been recommended by our team of experts.

If you are unsure on how to use any tool, refer to the manufacturers user manual before continuing.



RECOMMENDED TOOLS & SAFETY EQUIPMENT



Tape Measure



Ladder



Impact Driver



Circular Saw



String Line



Safety Clothing



Impact Drill



Set Square



Jigsaw Cutter



Spirit Level



Clamp

Installing Composite Battens

We advise using composite battens when installing Assured Composite Cladding even though there are various other options that can be used -steel, aluminium, plastic or timber.

Ensure the wall is solid and flat and the area is clear and free from any obstacles including cables and pipes.

Measure and cut battens where required.

Fix battens into position leaving 300mm max intervals between each batten centre to centre. Leave 10mm expansion gaps from the ground and roof and at batten butt joins.

Fix battens into place with expansion screws by drilling holes through the middle groove of each batten and into the wall. Start at 80mm approx then at 500mm approx intervals.

Double batten where cladding boards meet at butt joins allowing a 3mm gap between battens.

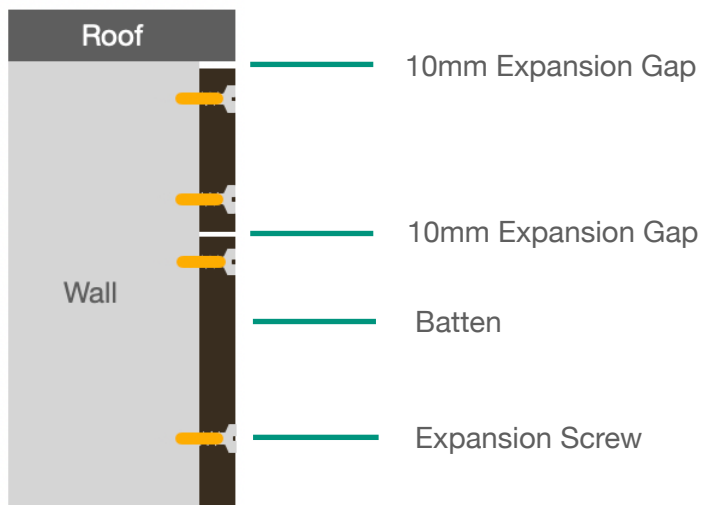

BATTEN SUPPORTS

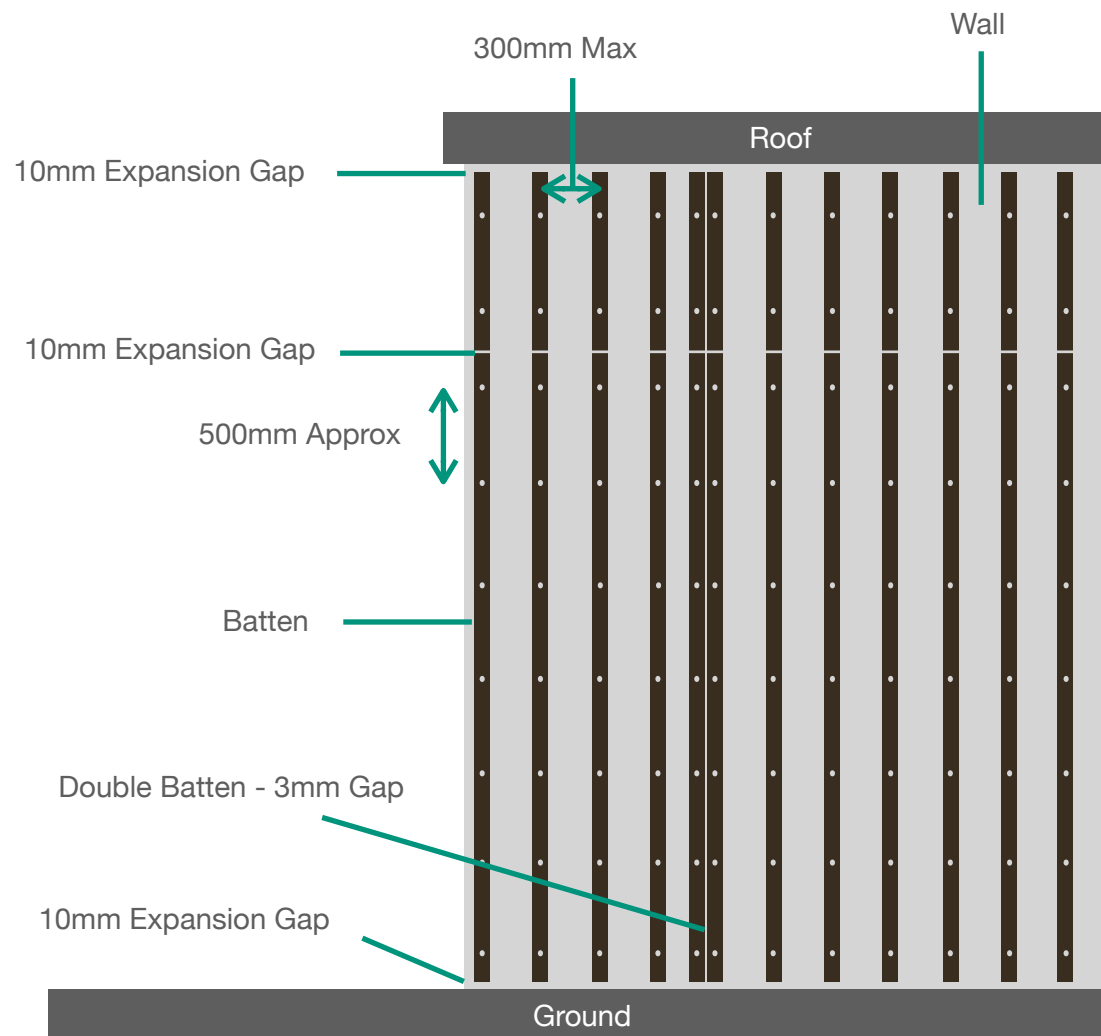

Installing Assured Cladding Boards

Fix starter clips to the framework at every batten leaving 20mm from the ground. Screw through the hole on each starter clip with the screws provided ensuring that the screws are fully screwed into place to prevent catching on the cladding board when installed.

Clip the first cladding board into the starter clips ensuring that the cladding board is securely clipped into all starter clips before continuing.

Screw through the top groove of the cladding board and into each batten to secure the cladding board. Ensure that the screws are fully screwed into place to prevent catching on the next cladding board.



CLADDING & ACCESSORIES

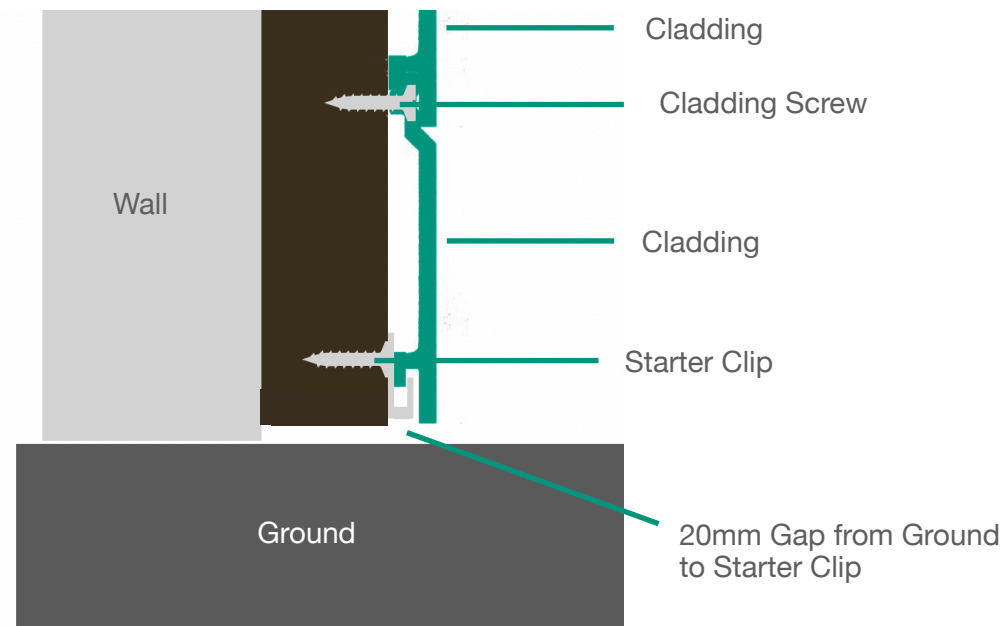
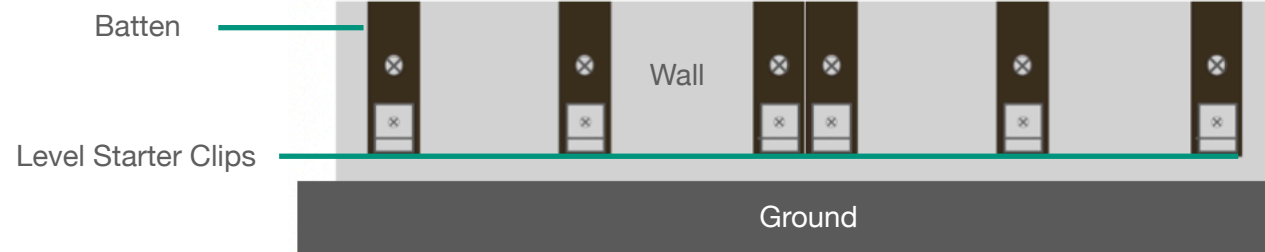

Installing Assured Cladding Boards

Continue with the same process until the last cladding board, cutting cladding boards where required. Leave 8mm expansion gaps between cladding board joins.

If the last cladding board does not fit as a whole then cut cladding board to size.

Cut and fix supporting blocks to each batten to support cladding board where required.

Fix into place by screwing through the face of the cladding board, through the supporting block and into each batten.

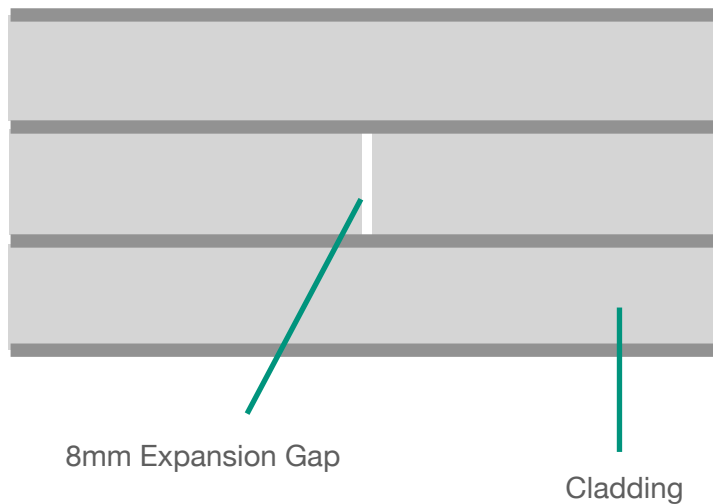

CLADDING & ACCESSORIES

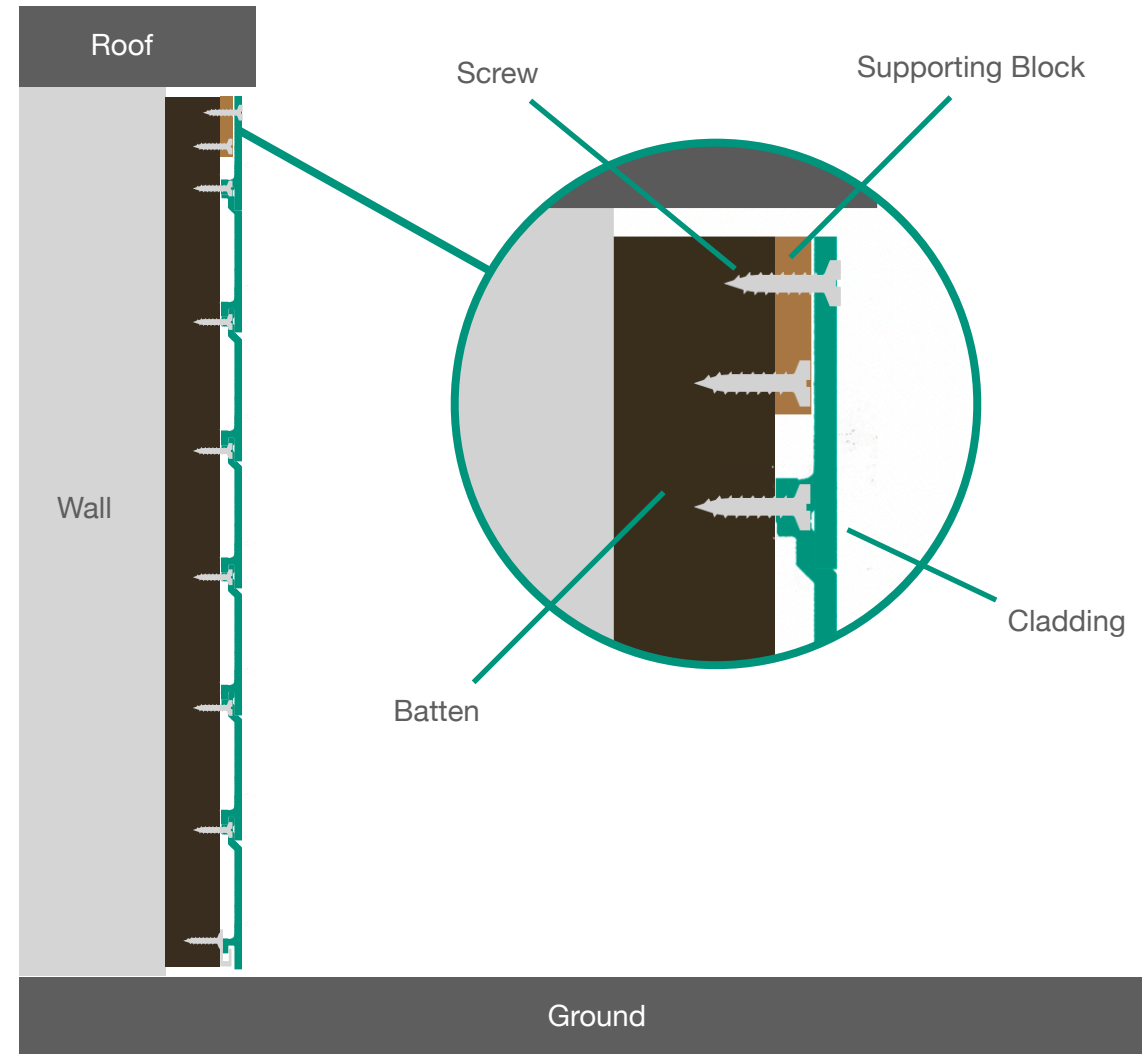

Installing Assured Corner Trim

Carefully plan the area checking all measurements.

Measure and cut corner trim where required.

Fix the corner trim by covering the cladding board edge. Pre-drill holes and fix into place by screwing directly through the corner trim and into the cladding board. Start at 80mm approx and then at every 300mm approx intervals. Leave a 2mm expansion gap when joining corner trim.

Corner trim can also be fixed into place using a high bond strength grab adhesive.



CLADDING & ACCESSORIES

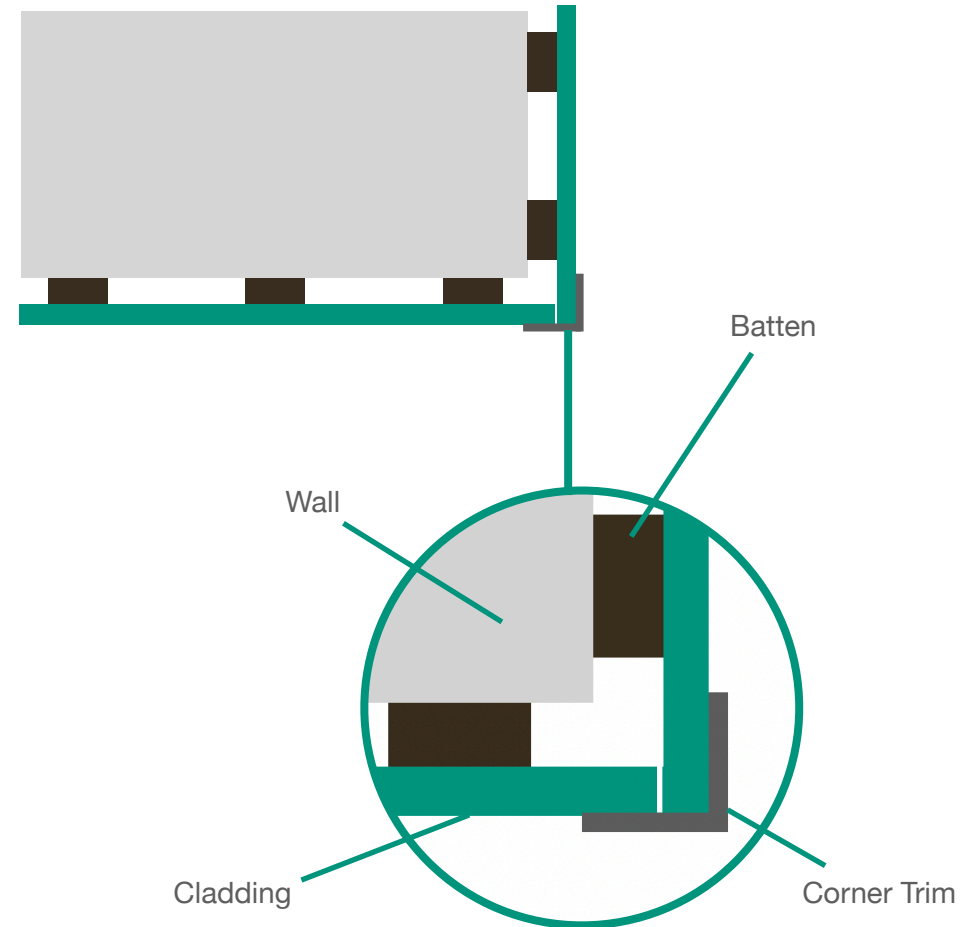

Installing Assured Fascia

Carefully plan the area checking all measurements.

Measure and cut fascia where required.

Fix the fascia by pre-drilling holes top and bottom and screwing through the face of the fascia. Start at 80mm approx then at every 300mm approx intervals. Ensure that the fascia finishes flush with the cladding board. Leave a 2mm expansion gap when joining fascia.

Fascia can also be fixed into place using a high bond strength grab adhesive.



CLADDING & ACCESSORIES

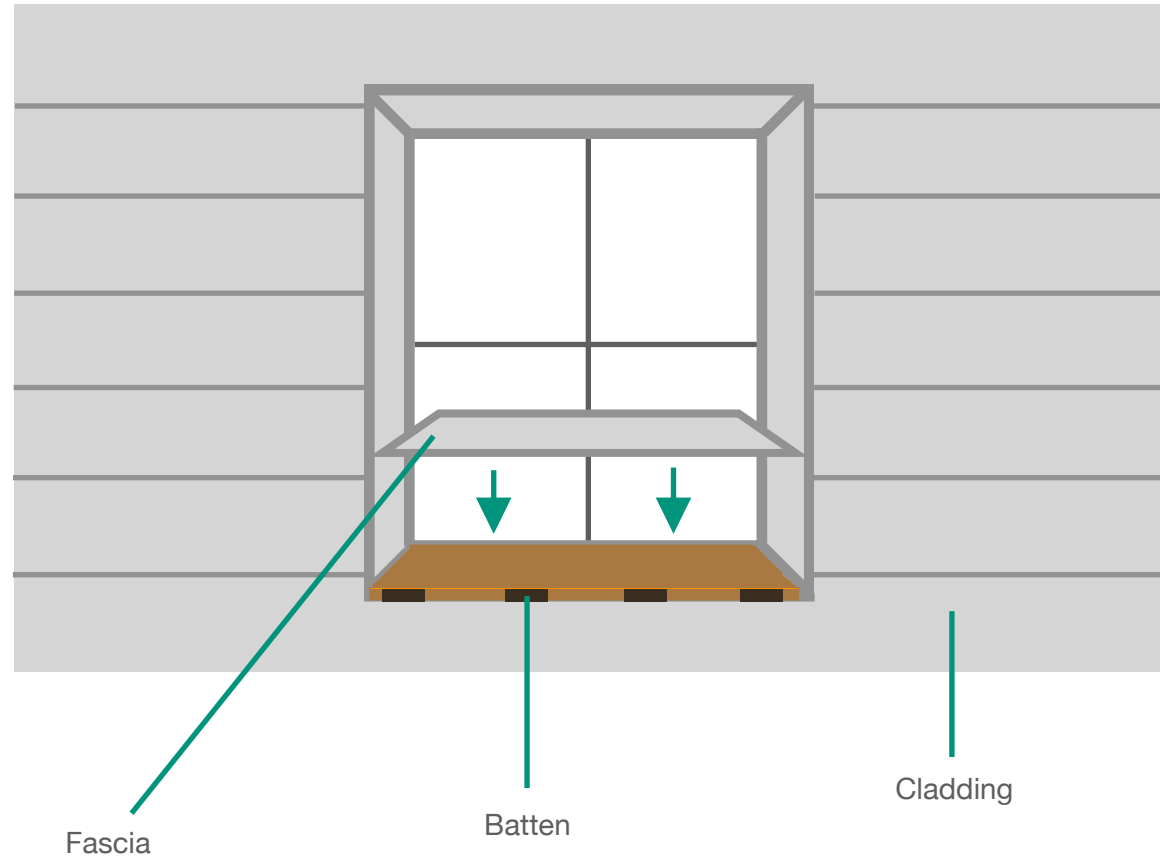



Still need help or have any questions?

Get in touch with a member of our team or visit our website for more information.

+44(0) 1664 400140

info@assuredcomposite.com

www.assuredcomposite.com

